**ZINWELL®****CORPORATION**

Specifications

Eutelsat & Astra Monoblock LNB : ZKF - DJ21

	Low Band	Hi Band
1. Input Frequency Range x2	10.7 ~ 11.7 GHz	11.7 ~ 12.75 GHz
2. Output Frequency Range	950 ~ 1950 MHz	1100 ~ 2150 MHz
3. L.O. Frequency	9.75 GHz	10.6 GHz
4. Noise Figure	0.7 dB (Typ.)	
5. F/D Ratio	0.6	
6. Input Reflector Type	Offset	
7. Cross Pol. Isolation	22 dB (Min.)	28 dB (Typ.)
8. Conversion Gain	50 dB (Min.)	62 dB (Max.)
9. Gain Flatness	± 0.5 dB / 27 MHz	
10. L.O. Frequency Stability (25 °C) (- 30 °C ~ 60 °C)	± 1 MHz ± 3 MHz	
11. L.O. Phase Noise (1 KHz Offset) (10 KHz Offset) (100 KHz Offset)	- 60 dBc/Hz - 80 dBc/Hz - 100 dBc/Hz	
12. Output Power (at 1dB Gain Compression Point)	0 dBm (Min.)	
13. Output Return Loss	7.5 dB	
14. Output Connector	75Ω F Type (Female)	
15. D.C. Supply Voltage	11.5 ~ 19 V	
16. D.C. Current Consumption	120 mA (Typ.)	150 mA (Max.)
17. Polarity, Band & Satellite Selection	See DiSEqC Command Table **	
18. Operating Temperature	- 30 °C ~ 60 °C	

Mechanical Drawing

DiSEqC Command	Output
Lo · V · SA	Eutelsat, Lo Band, Vertical
Hi · V · SA	Eutelsat, Hi Band, Vertical
Lo · H · SA	Eutelsat, Lo band, Horizontal
Hi · H · SA	Eutelsat, Hi Band, Horizontal
Lo · V · SB	Astra, Lo Band, Vertical
Hi · V · SB	Astra, Hi Band, Vertical
Lo · H · SB	Astra, Lo band, Horizontal
Hi · H · SB	Astra, Hi Band, Horizontal

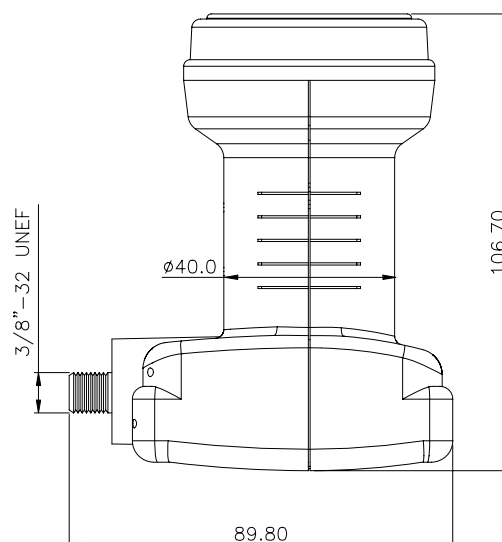
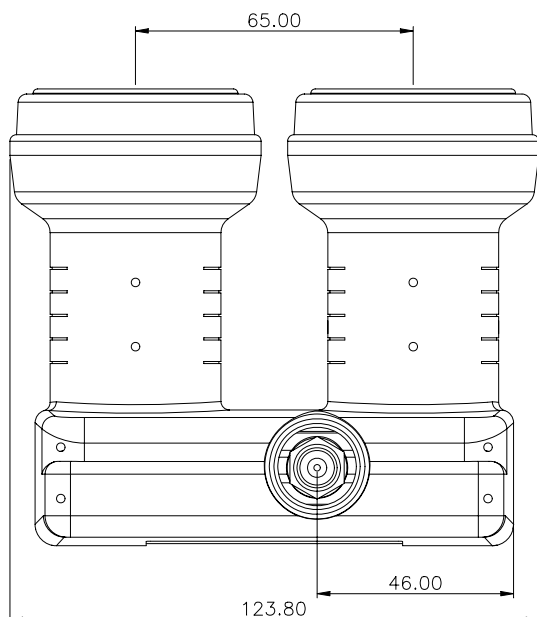
**Unit: mm.**

** This DiSEqC Command meet Eutelsat Recommendation.
Specifications are subject to change without notice.